



Buena Vista Park Capital Improvement Plan

Community Meeting 1
February 10, 2015



Dawn Kamalanathan , Project Manager
*Director Of Capital & Planning Division
Recreation and Park Department*

Lizzy Hirsch, Landscape Architect
Gabriel Meil, Landscape Architect
Public Works

Buena Vista Steering Committee

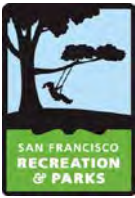

Capital Improvement Strategy Plan: Two-Part Approach

1. Long Term: Establish overall magnitude of costs for entire park upgrade and restoration strategies for future big funding opportunities.
2. Short Term: Identify & prioritize 5+/- small (500K) high priority projects that can be funded with grant opportunities or other city funds.



Part 1: Buena Vista Park role within city context

Part II: Buena Vista Park Site Assessment:
Forest, Circulation & Programs, Erosion and Irrigation

Part III: Buena Vista Park Potential Projects and Zones

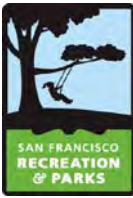

SAN FRANCISCO
PUBLIC
WORKS

Buena Vista Park 1873

Buena Vista Park Capital Improvement Plan





SAN FRANCISCO
PUBLIC
WORKS

SF Hilltop Park Context: Buena Vista Park

Buena Vista Park Capital Improvement Plan

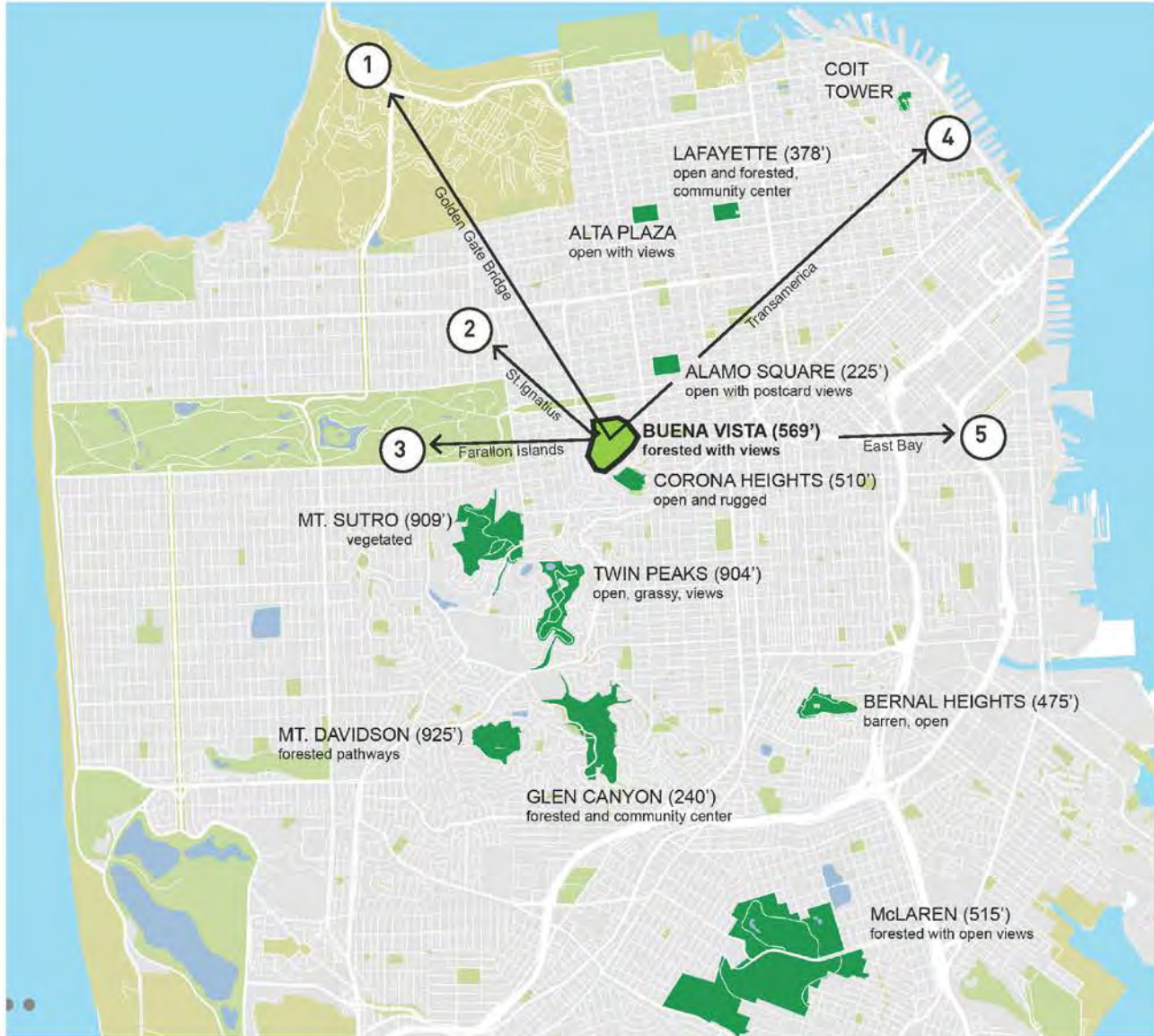



SAN FRANCISCO
PUBLIC
WORKS

Buena Vista vs. Corona Heights

Buena Vista Park Capital Improvement Plan





SAN FRANCISCO
PUBLIC
WORKS

Buena Vista Park Identity: Woodland Haven Within City

Buena Vista Park Capital Improvement Plan





Park Region Diagram

Buena Vista Park Capital Improvement Plan





Comments?

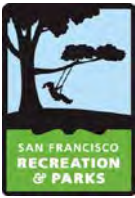

Planning and Assessment Projects/ Capital Projects

Buena Vista Park Capital Improvement Plan

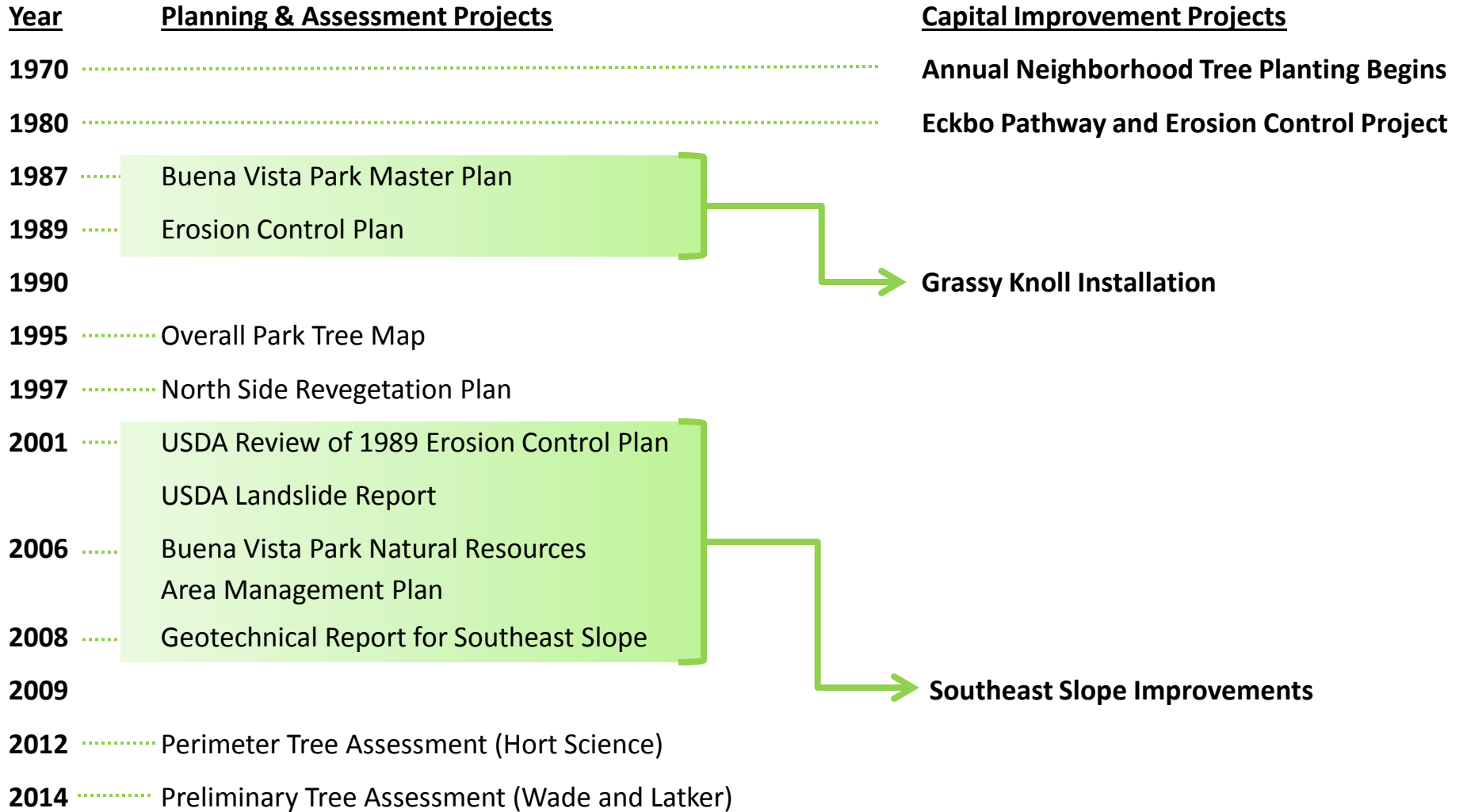



SAN FRANCISCO
PUBLIC
WORKS

Tree Grouping Diagram: Cypress

Buena Vista Park Capital Improvement Plan



LEGEND		AGE
	Cypress	120
	Pine	
	Eucalyptus	
	Oak	
	Redwood	
	Special	
	Lawn	



Tree Grouping Diagram: Pine

Buena Vista Park Capital Improvement Plan

The Monterey Pines are in serious decline and much of the existing massings are being taken over by other trees species (or nothing at all).



LEGEND	AGE
	Cypress
	Pine 120
	Eucalyptus
	Oak
	Redwood
	Special
	Lawn



Tree Grouping Diagram: Oak

Buena Vista Park Capital Improvement Plan



LEGEND	AGE
	Cypress
	Pine
	Eucalyptus
	Oak 80-100
	Redwood
	Special
	Lawn



SAN FRANCISCO
PUBLIC
WORKS

Tree Grouping Diagram: Eucalyptus

Buena Vista Park Capital Improvement Plan

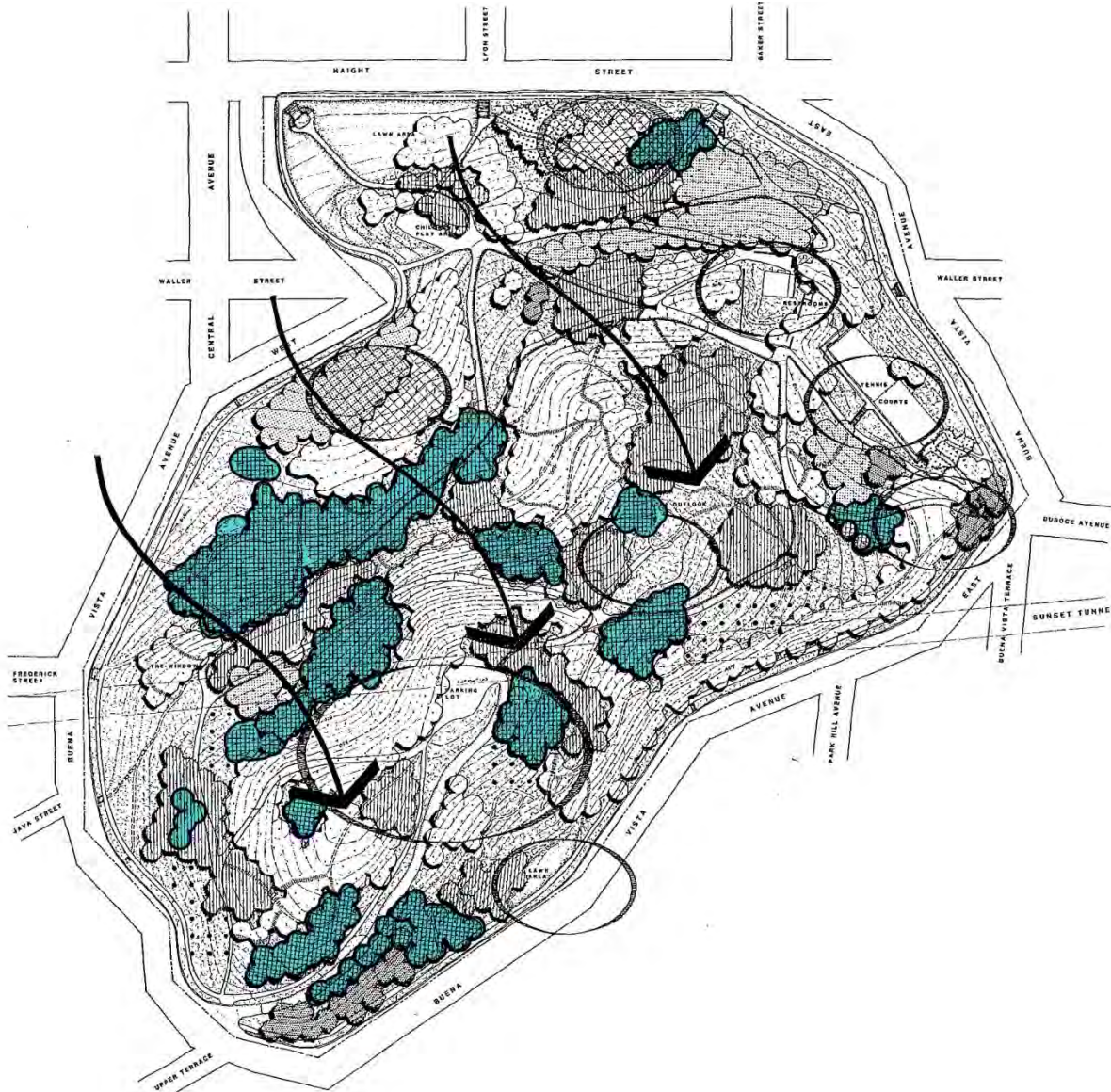

LEGEND	AGE
	Cypress
	Pine
	Eucalyptus 100
	Oak
	Redwood
	Special
	Lawn



SAN FRANCISCO
PUBLIC
WORKS

Tree Grouping Diagram: Redwood

Buena Vista Park Capital Improvement Plan



LEGEND	AGE
	Cypress
	Pine
	Eucalyptus
	Oak
	Redwood 60
	Special
	Lawn









Tree Grouping Diagram: Special

Buena Vista Park Capital Improvement Plan



Special Trees include mixture of Liquidambar, Mayten, Poplar, and Olive

LEGEND	AGE
	Cypress
	Pine
	Eucalyptus
	Oak
	Redwood
	Special VARIES
	Lawn



Tree Grouping Diagram: Overall & Goals

Buena Vista Park Capital Improvement Plan

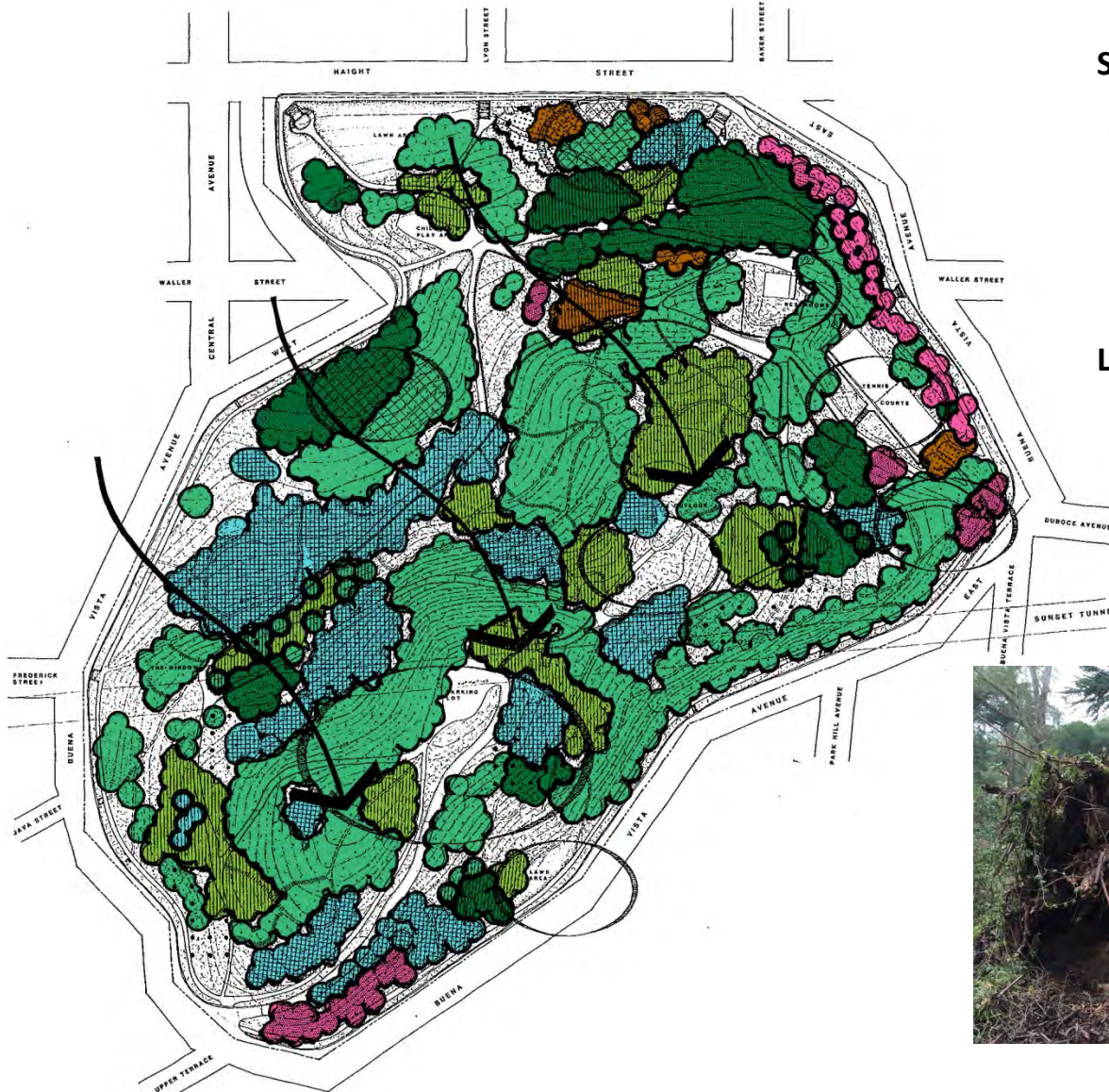

Short Term:

1. Remove / Prune Hazardous Trees.
2. Diseased and Aging Pines continue to decline and need to be assessed regularly.
3. Reforest Critical Areas.

Long Term:

1. Create / Implement Sustainable Forest Management Plan.

LEGEND		Approximate Age (yrs)
	Cypress	120
	Pine	120
	Eucalyptus	100
	Oak	80 -100
	Redwood	60
	Special	varies
	Lawn	



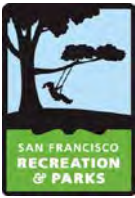

Existing Circulation and Program: Primary

Buena Vista Park Capital Improvement Plan

- Entry Point
- Accessible Entry Point





Existing Circulation and Program: Secondary

Buena Vista Park Capital Improvement Plan

- Entry Point
- Accessible Entry Point





Existing Circulation and Program: Tertiary

Buena Vista Park Capital Improvement Plan

- Entry Point
- Accessible Entry Point





Circulation: Potential Paths to Remove

Buena Vista Park Capital Improvement Plan

■ Entry Point

■ Accessible Entry Point

— Proposed path to remove

ISSUES:

1. Complex Path system that is difficult to maintain.
2. Slopes susceptible to erosion from foot traffic and dogs.

SOLUTIONS:

1. Simplify path system.
2. Protect hillside with fencing.
3. Alternate dog park location.





SAN FRANCISCO
PUBLIC
WORKS

Circulation and Erosion Control Areas

Buena Vista Park Capital Improvement Plan





SAN FRANCISCO
**PUBLIC
WORKS**

Circulation and Erosion Control Areas

Buena Vista Park Capital Improvement Plan



Erosion Fencing options





Antiquated Irrigation Diagram

Buena Vista Park Capital Improvement Plan

● Existing Quick Coupler





Comments?

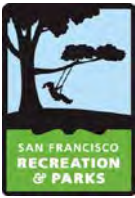

Park Region Diagram

Buena Vista Park Capital Improvement Plan





Perimeter Region

Buena Vista Park Capital Improvement Plan

- Primary Entry
- Secondary Entry
- Accessible Entry
- Informal "Rock Steps"
- Perpendicular Parking
- Parallel Parking

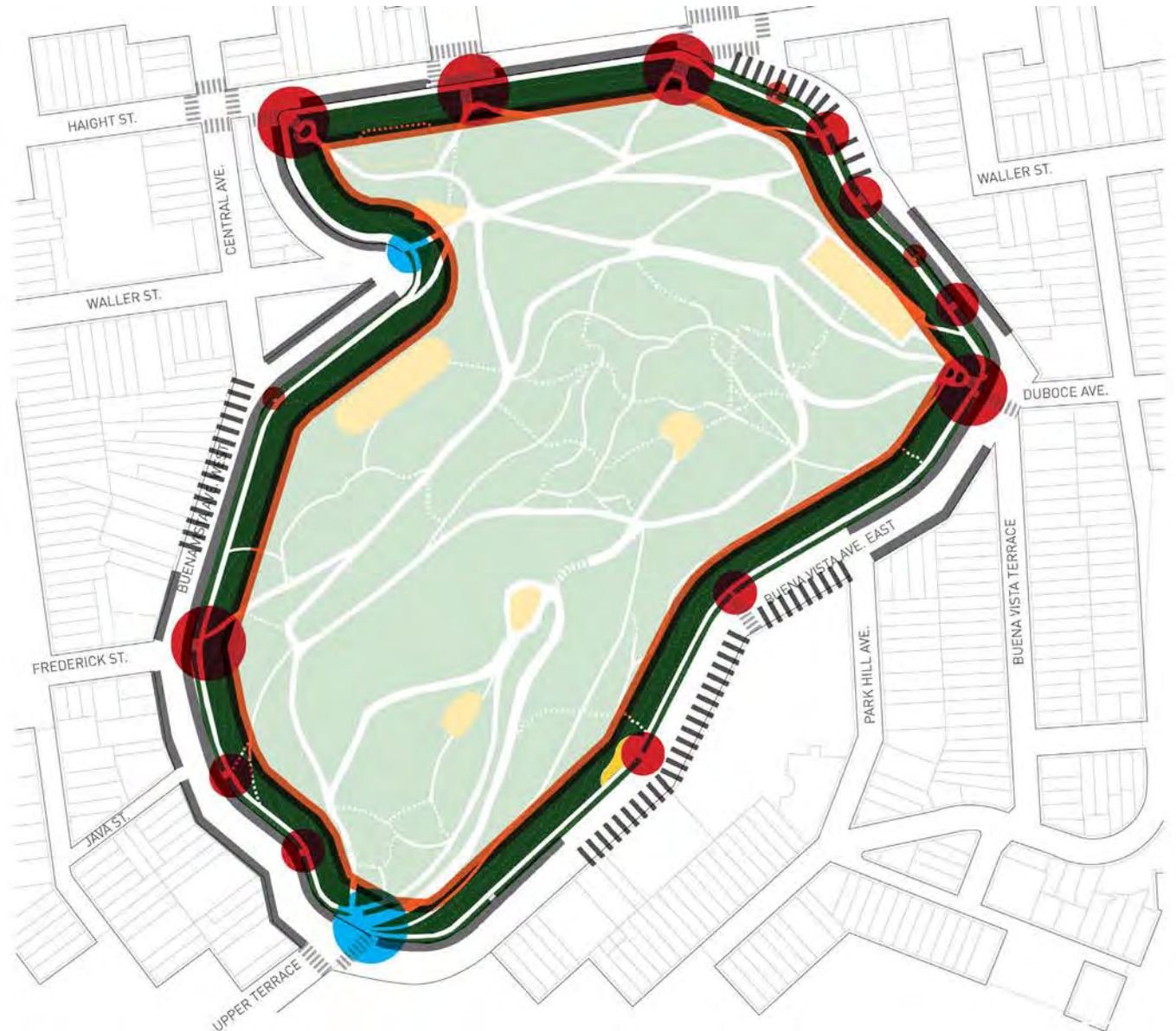



SAN FRANCISCO
**PUBLIC
WORKS**

Perimeter: Buena Vista East

Buena Vista Park Capital Improvement Plan





SAN FRANCISCO
**PUBLIC
WORKS**

Perimeter: Haight

Buena Vista Park Capital Improvement Plan

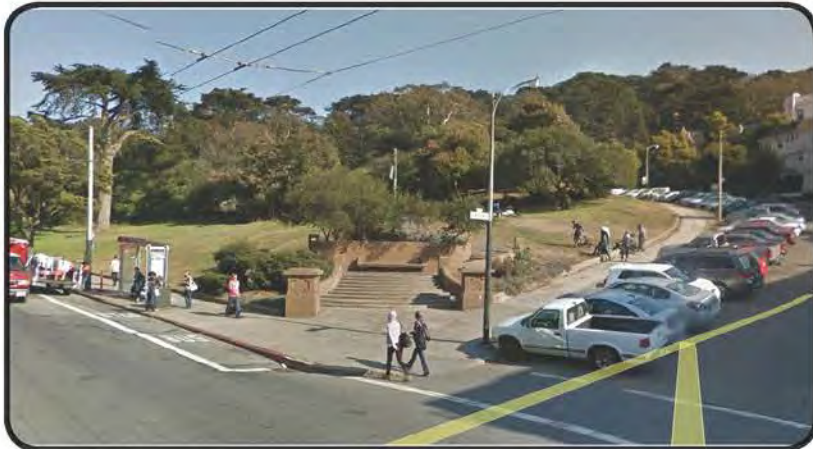



SAN FRANCISCO
**PUBLIC
WORKS**

Perimeter: Buena Vista West

Buena Vista Park Capital Improvement Plan





Perimeter: Character & Patterns

Buena Vista Park Capital Improvement Plan



PRIMARY ENTRY STAIR



SECONDARY STAIR

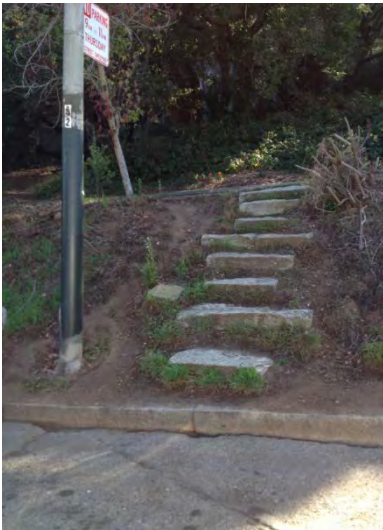

INFORMAL "STAIR"



ERODED SLOPE, BUTTRESSED BY
TEMPORARY RETAINING LOGS



PROMINADE WALK



FAILING EDGE



Perimeter: Potential Projects

Buena Vista Park Capital Improvement Plan

1. Design Goals:

- Introduce consistent edge treatment along roadway
- Build park identity with consistent signage/wayfinding
- Celebrate primary entries

2. Infrastructure:

- Erosion Control
- Irrigation
- Improve compromised paths
- Introduce more “informal” stairs to deter “cutting” across perimeter berm
- Introduce lighting

3. Tree Management:

- Remove hazardous trees
- Implement Forest Management Plan

4. Landscape Management:

- Create attractive, consistent, drought-tolerant landscape

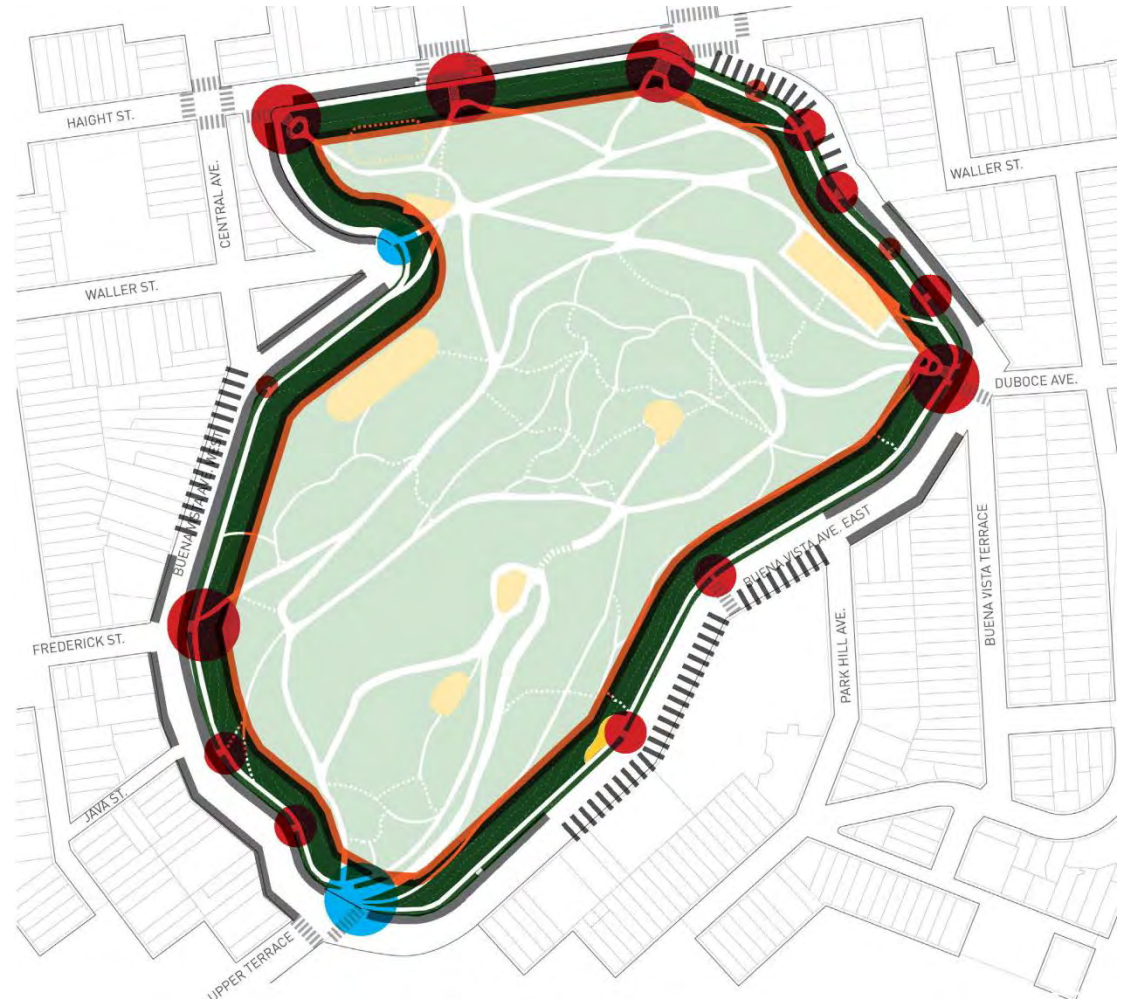



SAN FRANCISCO
**PUBLIC
WORKS**

Woodland Region

Buena Vista Park Capital Improvement Plan



ADA PATH/ BOARDWALK



WOOD STAIRS



ENDURING STONE WALL / ASPHALT PATH





Woodland: Potential Projects

Buena Vista Park Capital Improvement Plan

1. Design Goals:

- Build park identity with consistent signage/wayfinding
- Enhance “The Window”
- Prune / Manage trees to frame important vistas

2. Infrastructure:

- Simplify path network and create protected erosion control areas
- Irrigation
- Renovate compromised paths
- Renovate Child Play Area
- Shift dog play area

3. Tree Management:

- Remove hazardous trees
- Implement Forest Management Plan

4. Landscape Management:

- Create attractive, consistent, drought-tolerant landscape





SAN FRANCISCO
**PUBLIC
WORKS**

Ridge Region

Buena Vista Park Capital Improvement Plan



THE OVERLOOK



THE GROVE



THE GRASSY KNOLL





Ridge: Potential Projects

Buena Vista Park Capital Improvement Plan

1. Design Goals:

- Build park identity with consistent signage/wayfinding
- Enhance the three gathering spots-- The Overlook, Grassy Knoll, and Grove--to reflect the inherent and unique qualities of each space

2. Infrastructure:

- Erosion control
- Irrigation
- Remove fallen trees
- Extend ADA path to the Overlook

3. Tree Management:

- Remove hazardous trees
- Implement Forest Management Plan

4. Landscape Management:

- Create attractive, consistent, drought-tolerant landscape





Feedback on Priorities

Buena Vista Park Capital Improvement Plan

Priorities:

- Perimeter Zone
- Woodland Zone
- Ridge Zone

Goals:

1. Long Term: Establish overall magnitude of costs for entire park upgrade and restoration strategies for future big funding opportunities.
2. Short Term: Identify & prioritize 5+/- small (500K) high priority projects that can be funded with grant opportunities or other city funds.





SAN FRANCISCO
PUBLIC
WORKS

Buena Vista Park Identity: Woodland Haven Within City

Buena Vista Park Capital Improvement Plan





Next Steps

Buena Vista Park Capital Improvement Plan

1. Collect and assess feedback on goals and priorities
2. Develop potential project scenarios for community review
3. Next Community Meeting Late March



Thank you!